

Seismic Evaluation of G+2 Institutional Building in Bhopal

Aakash Saxena

Dr. S.S. Kushwaha

Department of Civil Engineering, UIT (RGPV), Bhopal (MP)

ABSTRACT- A Seismic design is aimed at controlling the structural damage based on precise estimations of proper response parameters. Seismic design explicitly evaluates how a building is likely to perform; given the potential hazard it is likely to experience, considering uncertainties inherent in the quantification of potential hazard and uncertainties in assessment of the actual building response. It is an interactive process that begins with the selection of performance objectives, followed by the development of a preliminary design, an assessment as to whether or not the design meets the performance objectives, and finally redesign and reassessment, if required, until the desired performance level is achieved.

In this present study one R.C. buildings, of G + 2 storey institutional building (designed according to IS 456:2000) are analysed. Analysis and redesigning by changing the main reinforcement of various frame elements and again analyzing. The structural analysis has been carried out using STAAD.Pro V8i, a product of Structural Analysis and Design Program. A total of 1 cases for a particular G + 2 storey institutional building located in Zone-II have been analyzed. The results of analysis are compared in terms of reinforcement in the column and beam. The best possible combination of reinforcement that is economical, effective and whose damage is limited to Grade 2 (slight structural damage, moderate non structural damage) in order to enable Immediate Occupancy is determined and is termed as Seismic Design.

INTRODUCTION

Amongst the natural hazards, earthquakes have the potential for causing the greatest damages. Since earthquake forces are random in nature & unpredictable, the engineering tools needs to be sharpened for analyzing structures under the action of these forces. Performance based design is gaining a new dimension in the seismic design philosophy wherein the near field ground motion (usually acceleration) is to be considered. Earthquake loads are to be carefully modelled so as to assess the real behaviour of structure with a clear understanding that damage is expected but it should be regulated. In this context pushover analysis which is an interactive procedure shall be looked upon as an alternative for the orthodox analysis procedures. This study focuses on pushover analysis of multi-storey RC framed buildings subjecting them to monotonically increasing lateral forces with an invariant height wise distribution until the preset performance level (target displacement) is reached. The promise of performance-based seismic engineering (PBSE) is to produce structures with predictable seismic performance. To turn this promise into a reality, a comprehensive and well-coordinated effort by professionals from several disciplines is required.

Performance based engineering is not new. Automobiles, airplanes, and turbines have been designed and manufactured using this approach for many decades. Generally in such applications one or more full-scale prototypes of the structure are built and subjected to extensive testing. The design and manufacturing process is then revised to incorporate the lessons learned from the experimental evaluations. Once the cycle of design, prototype manufacturing, testing and redesign is successfully completed, the product is manufactured in a massive scale. In the automotive industry, for example, millions of automobiles which are virtually identical in their mechanical characteristics are produced following each performance-based design exercise.

The primary objective of this work is to compare the design of building with and without seismic forces by variation in reinforcement by using STAAD.Pro of RC framed building designed. The effect of earthquake force on G+2 storey institutional building of Bhopal, with the help of STAAD.Pro, for various different sets of reinforcement at different levels has been investigated.

Some of the prominent literature on the topic are as follows:

S.Mahesh and Dr.B.Panduranga Rao (2014) considered the behaviour of G+7 multi story building of regular and irregular configuration under earthquake. A residential of G+7 multi story building is studied for earthquake and wind load using STAAD.Pro V8i .Assuming that material properties and static and dynamic analysis is performed. These analysis are carried out by considering different seismic zones and for each zone the behaviour is assessed by taking three different types of soils namely Hard , Medium and Soft .

Kevadkar, Kodag et.al. (2013) observed that the structure heavy susceptible to lateral forces may be concerned to severe damage. In this they found that along with gravity load (dead load, live load) the frames are able to withstand to lateral load (loads due to earthquake, wind, blast, fire hazards etc.) which can develop high stresses. For that purpose they used shear wall and steel bracing system to resist such type of loading like earthquake, wind, blast etc. In this study according to author R.C.C. building is modeled and analyzed in STAAD.Pro and results are compared in terms of Lateral Displacement, Storey Shear and Storey Drifts, Base shear and Demand Capacity (Performance point).

P.B. Kulkarni et. al. (2013) Masonry infill walls are mainly used to increase initial stiffness and strength of reinforced concrete (RC) frame buildings. It is mainly considered as a non-structural element. In this paper, symmetrical frame of college building (G+5) located in seismic zone-III is considered by modeling of initial frame. With reference to FEMA-273, & ATC-40 which contain the provisions of calculation of stiffness of infilled frames by modeling the infill panels are modeled as a equivalent diagonal strut method. This linear static analysis is to be carried out on the models such as bare frame, strut frame, strut frame with centre & corner opening, which is performed by using computer software STAAD.Pro from which different parameters are computed. In which it shows that infill panels increase the stiffness of the structure. While the increase in the opening percentage leads to a decrease on the lateral stiffness of infilled frame.

Salehuddun (2011) focused on nonlinear geometric analysis to be compared with linear analysis. In this study, a six storey 2-D steel frame structure with 24 m height has been selected to be idealized as tall building model. The model was analyzed by using SAP2000 structural analysis software with the consideration of geometric nonlinear effect. This study showed that a steel frame with the consideration of wind load produce greater sway value as compared to the steel frame without wind load

Gajjar and DhavalP.Advani(2011) focused on the design of multi-storeyed steel buildings to have good lateral load resisting system along with gravity load system because it also governs the design. This paper is presented to show the effect of different types of bracing systems in multi storied steel buildings. For this purpose the 20 stories steel buildings models is used with same configuration and different bracings systems such as knee brace, X brace and V brace is used. A commercial package STAAD.Pro is used for the analysis and design and different parameters are compared. The property of the section is used as per IS 800:2007 which incorporates Limit State Design philosophy.

Kevadkar, Kodag et.al. (2013) observed that the structure heavy susceptible to lateral forces may be concerned to severe damage. In this they found that along with gravity load (dead load, live load) the frames are able to withstand to lateral load (loads due to earthquake, wind, blast, fire hazards etc) which can develop high stresses. For that purpose they used shear wall and steel bracing system to resist such type of loading like earthquake, wind, blast etc. In this study according to author R.C.C. building is modeled and analyzed in STAAD.Pro and results are compared in terms of Lateral Displacement, Storey Shear and Storey Drifts, Base shear and Demand Capacity (Performance point).

Qiang Xue, Chia-Wei Wu et al (2007) summarized the development of the seismic design draft code for buildings in Taiwan using performance-based seismic design methodology and case studied. They presented the design of a reinforced concrete building by using the draft code. Seismic design code provisions are examined according to the theoretical basis of PBSB to identify which methodologies of PBSB need to be incorporated into the current seismic design code. The performance-based seismic design code introduces a transparent platform in which the owners and designers can exchange their views on the expected seismic performance of the buildings under different levels of earthquakes.

METHODOLOGY

METHODOLOGY AND SELECTION OF PROBLEMS

In this present study one R.C. buildings, of G + 2 storey institutional building (designed according to IS 456: 2000) are analysed. Analysis and redesigning by changing the main reinforcement of various frame elements and again analyzing. The structural analysis has been carried out using STAAD.Pro V8i, a product of Structural Analysis and Design Program. Following steps are implemented in this study:-

Step-1 Selection of building geometry

Step-2 Selection of seismic zones

TABLE 1: SEISMIC ZONES FOR DIFFERENT CASES AND MODELS

Case	Model	Earthquake zones as per IS 1893 (part-1) : 2002
Case-1	RCC Structure	II

Step-3 Considering of load combination (13 load combinations)

TABLE 2: LOAD CASE DETAILS

Load case no.	Load case details
1.	E.Q. IN X DIR.
2.	E.Q. IN Z DIR.
3.	DEAD LOAD
4.	LIVE LOAD
5.	1.5 (DL + LL)
6.	1.5 (DL + EQX)
7.	1.5 (DL - EQX)
8.	1.5 (DL + EQZ)
9.	1.5 (DL - EQZ)
10.	1.2 (DL + LL + EQX)
11.	1.2 (DL + LL - EQX)
12.	1.2 (DL + LL + EQZ)
13.	1.2 (DL + LL - EQZ)

Step-4 Modelling of building frames using STAAD.Pro software.

Step-5 Results evaluation in terms of maximum bending moment, maximum shear force, axial force, maximum joint displacement and maximum section displacement

MATERIAL AND GEOMERICAL PROPERTIES

Following properties of material have been considered in the modelling -

Density of RCC: 25 kN/m³

Density of Masonry: 20 kN/m³ (Assumed)

Young's modulus of concrete: $5000\sqrt{f_{ck}}$

Poisson's ratio: 0.17

The foundation depth is considered at 1.5 m below ground level and the floor height is 4 m.

LOADING CONDITIONS

Following loadings are considered for analysis -

(a) **Dead Loads:** as per IS: 875 (part-1) 1987

Self wt. of slab

Slab = 0.15 x 25 = 3.75 kN/m² (slab thick. 150 mm assumed)

Floor Finish load = 1 kN/m²

Total slab load = 4.75 kN/m²

Masonry Wall Load = 0.25 m x 2.55 m x 20 kN/m³ = 12.75 kN/m

Parapet wall load = 0.25 m x 1 m x 20 kN/m³ = 5 kN/m

(b) **Live Loads:** as per IS: 875 (part-2) 1987

Live Load on typical floors = 3 kN/m²

Live Load in earthquake = 0.75 kN/m²

(c) **Earth Quake Loads:** All Structures are analyzed for 4 earthquake zones

The earth quake calculation are as per IS: 1893 (2002) [21]

a. Earth Quake Zone-II,III,IV,V

(Table - 2)

- | | |
|---|-------------------|
| b. Importance Factor: 1 | (Table - 6) |
| c. Response Reduction Factor: 5 | (Table - 7) |
| d. Damping: 5% | (Table - 3) |
| e. Soil Type: Medium Soil (Assumed) | |
| f. Period in X direction (PX): $\frac{0.09 \cdot h}{\sqrt{dx}}$ seconds | Clause 7.6.2 [21] |
| g. Period in Z direction (PZ): $\frac{0.09 \cdot h}{\sqrt{dz}}$ seconds | Clause 7.6.2 [21] |

Where h = height of the building
 dx = length of building in x direction
 dz = length of building in z direction

LOADING DIAGRAM

Typical diagram for different types of loading conditions are shown below

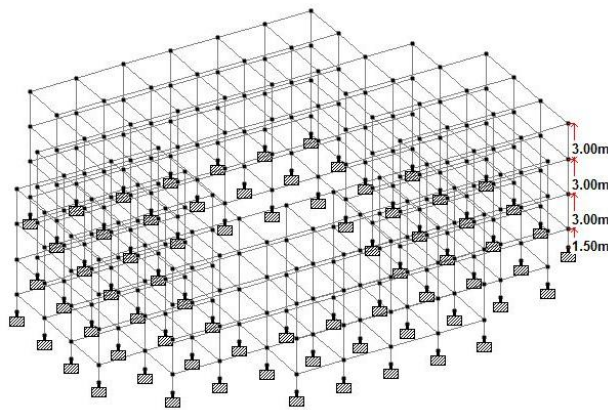

Figure 1 : Isometric view of institutional building

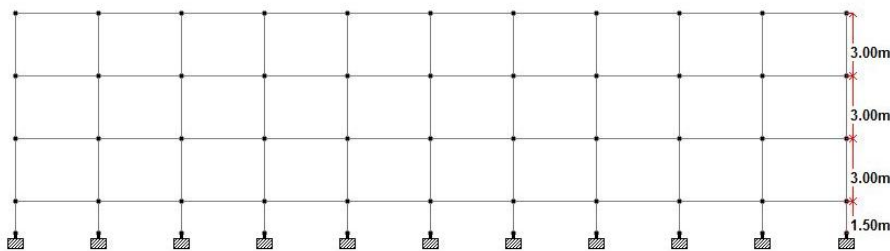

Figure 2 : Front view of institutional building

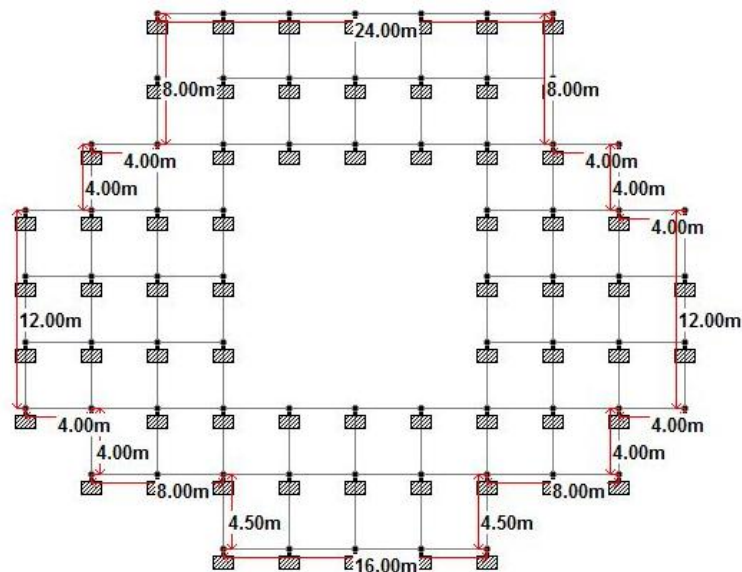

Figure 3 : Plan of institutional building

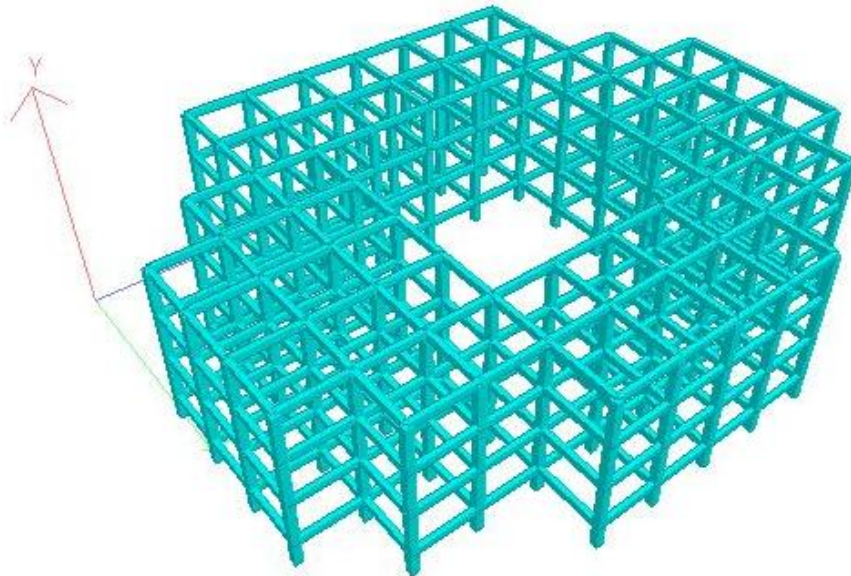

Figure 4 : 3D rendering view of institutional building

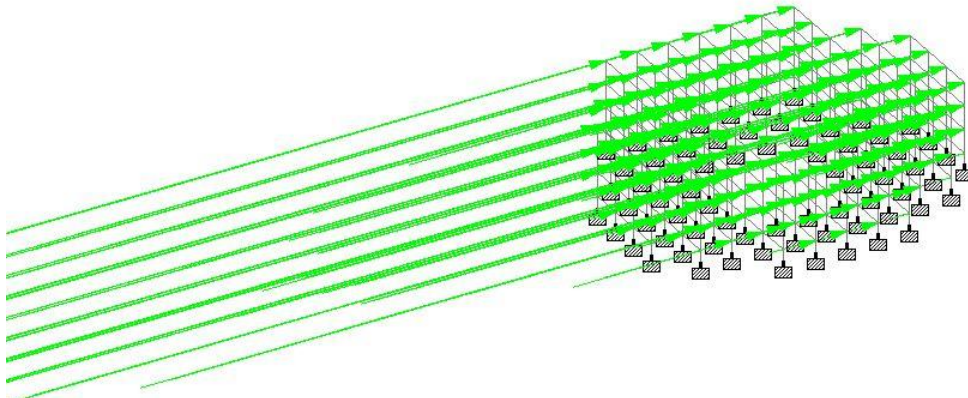

Figure 5 : Seismic loading in X direction of institutional building

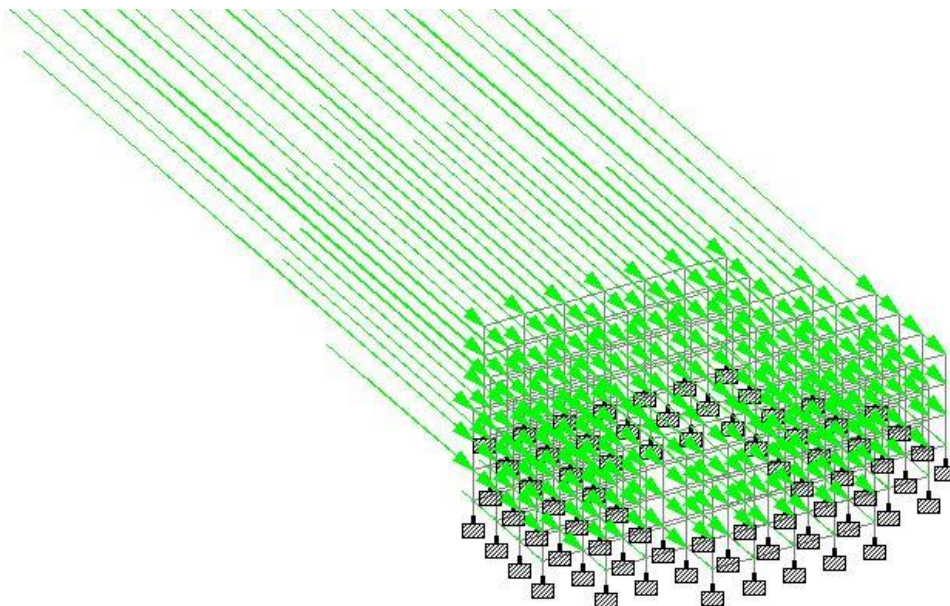

Figure 6 : Seismic loading in Z direction of institutional building

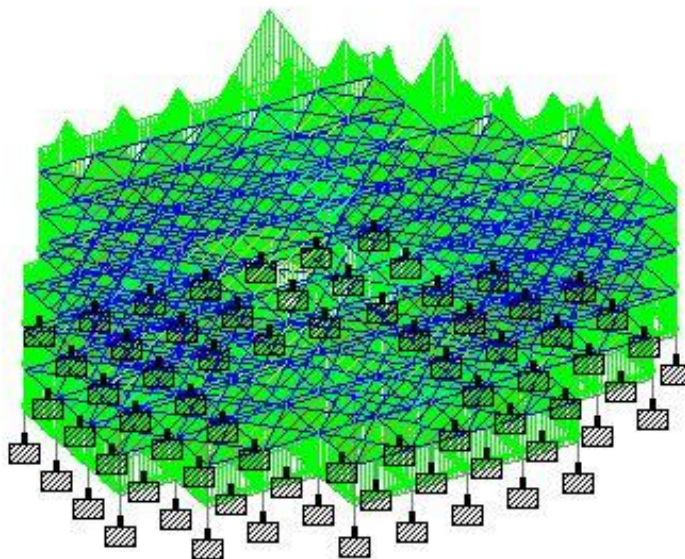

Figure 7 : Dead load of institutional building

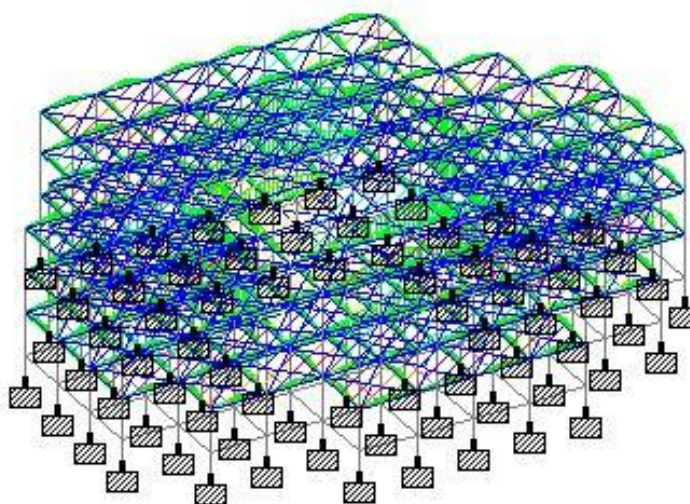

Figure 8 : Live load of institutional building

RESULT AND DISUSSION

The various results like maximum bending moment, maximum shear force, maximum axial force, maximum joint displacement and maximum section displacement are evaluated and effective and critical floor is determine among the structure considering seismic loading. Following tables and graphs are presented to find optimum system to resist seismic forces under following heads:-

A. Maximum Bending Moment

TABLE 3: MAX. BENDING MOMENT (Mz) kNm FLOOR WISE

MAX. BENDING MOMENT (Mz) kNm FLOOR WISE	
FLOOR	BENDING MOMENT kNm
GF	86.946
FIRST	164.067
SECOND	147.948
TOP	99.015

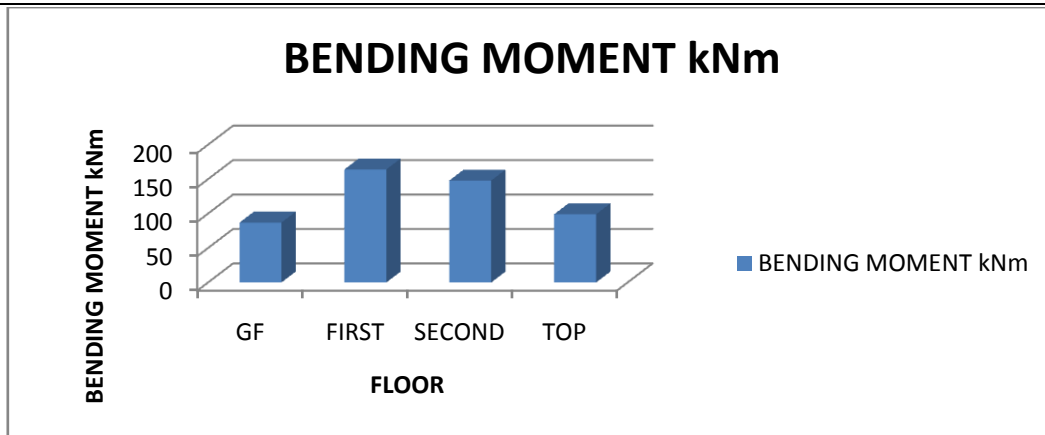

FIGURE 9: MAX. BENDING MOMENT (Mz) kNm FLOOR WISE

B. Shear Force

TABLE 4 : MAXIMUM SHEAR FORCE kN FLOOR WISE

MAXIMUM SHEAR FORCE kN FLOOR WISE	
FLOOR	SHEAR FORCE kN
GF	75.667
FIRST	189.15
SECOND	180.975
TOP	138.357

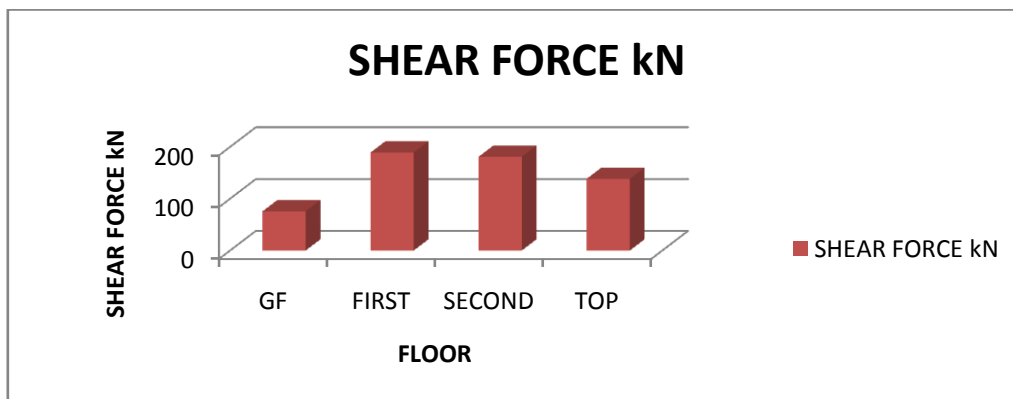

FIGURE 10: MAXIMUM SHEAR FORCE kN FLOOR WISE

C. Axial Force

TABLE 5: MAXIMUM AXIAL FORCE KN

MAXIMUM AXIAL FORCE KN	
FLOOR	AXIAL FORCE KN
BASE	1384.535
GF	1234.356
FIRST	783.897
SECOND	336.103

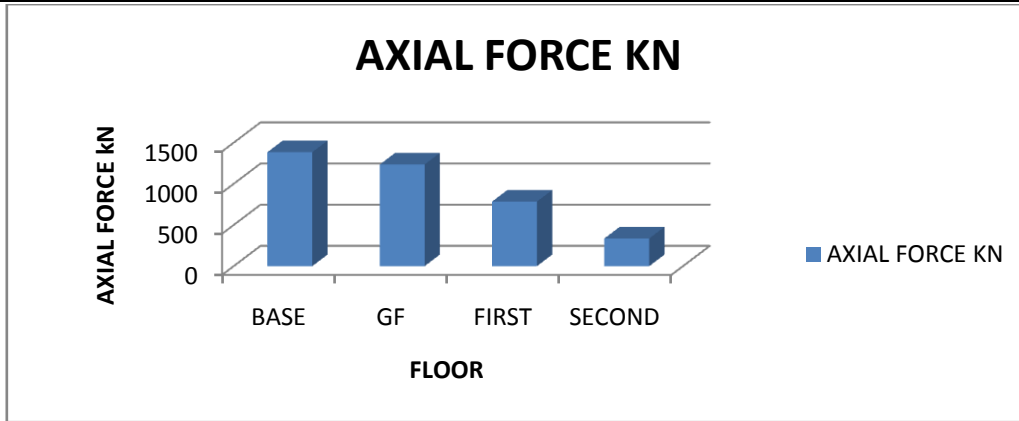

FIGURE 11 :MAXIMUM AXIAL FORCE KN

D. Maximum Joint Displacement

TABLE 6: MAX. JOINT DISPLACEMENT MM FLOOR WISE IN X DIRECTION

MAX. JOINT DISPLACEMENT MM FLOOR WISE	
FLOOR	DISPLACEMENT IN X DIRECTION
GF	0.701
FIRST	4.576
SECOND	8.484
TOP	11.029

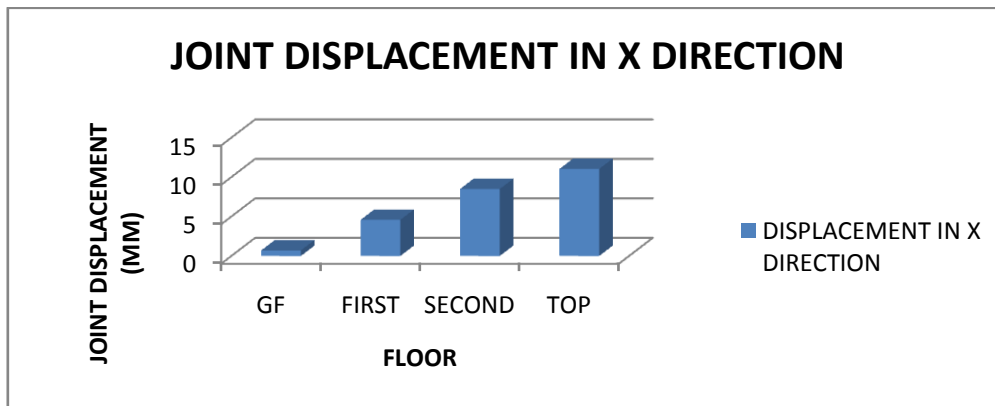

FIGURE 12: MAX. JOINT DISPLACEMENT MM FLOOR WISE IN X DIRECTION

TABLE 7: MAX. JOINT DISPLACEMENT MM FLOOR WISE IN Z DIRECTION

MAX. JOINT DISPLACEMENT MM FLOOR WISE	
FLOOR	DISPLACEMENT IN Z DIRECTION
GF	0.783
FIRST	5.126
SECOND	9.622
TOP	12.706

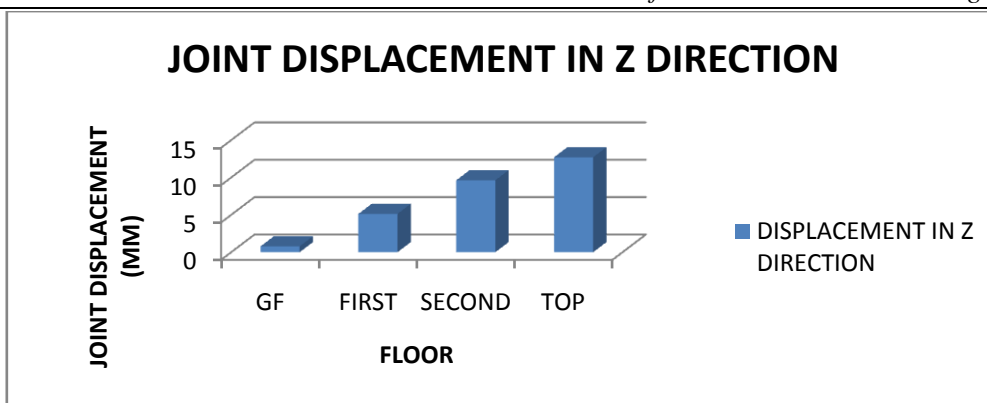

FIGURE 13: MAX. JOINT DISPLACEMENT MM FLOOR WISE IN Z DIRECTION

E. Maximum Section Displacement

TABLE 8: MAX. SECTION DISPLACEMENT MM FLOOR WISE IN X DIRECTION

MAX. SECTION DISPLACEMENT MM FLOOR WISE	
FLOOR	DISPLACEMENT IN X DIRECTION
GF	0.533
FIRST	1.175
SECOND	1.164
TOP	0.97

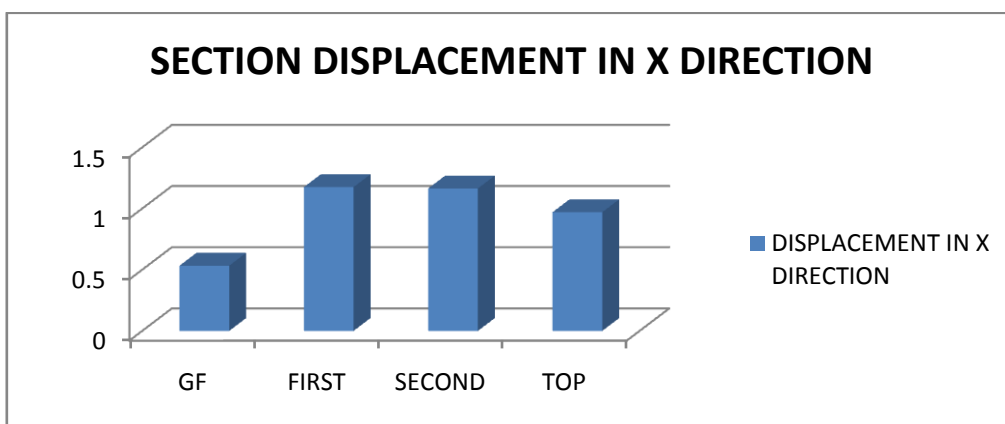

FIGURE 14: MAX. SECTION DISPLACEMENT MM FLOOR WISE IN X DIRECTION

TABLE 9: MAX. SECTION DISPLACEMENT MM FLOOR WISE IN Z DIRECTION

MAX. SECTION DISPLACEMENT MM FLOOR WISE	
FLOOR	DISPLACEMENT IN Z DIRECTION
GF	0.764
FIRST	1.455
SECOND	1.336
TOP	0.969

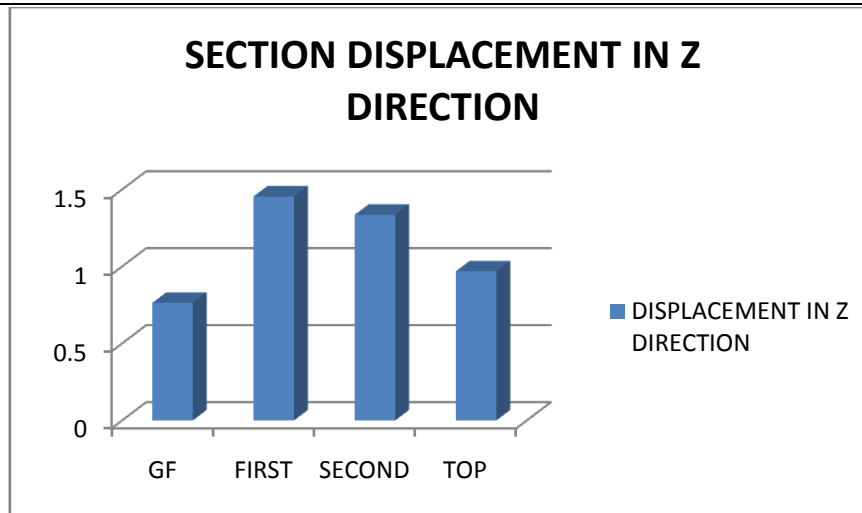

TABLE 15: MAX. SECTION DISPLACEMENT MM FLOOR WISE IN Z DIRECTION

CONCLUSIONS

In this study, performance of institutional building frames are studied considering various combination and seismic parameters. Results of this parametric study are as follows

1. In beam forces, maximum bending moment and maximum shear force are calculated and it is observe that second floor is critical and ground floor is efficient because of direct contact with soil and foundation.
2. In column force, maximum axial force is calculated and it is observed that maximum load is in base columns because it resist complete load of institutional building and as seen in top floor axial force is reduced up to 4 times of base
3. In joint displacement, maximum displacement is seen in top floor in both direction (X and Z direction)
4. In section displacement, maximum displacement is seen in first floor section in both direction (X and Z direction)

REFERENCES

- [1]. **S.Mahesh and Dr.B.Panduranga Rao** Comparison of analysis and design of regular and irregular configuration of multi Story building in various seismic zones and various types of soils using STAAD- Volume 11, Issue 6 Ver. I (Nov- Dec. 2014), PP 45-52
- [2]. Kevadkar M.D., Kodag P.B., 'Lateral load (loads due to earthquake, wind, blast, fire hazards etc) (earthquake loads, wind loads, blast, fire hazards etc) Analysis of R.C.C. Building', International Journal of Modern Engineering Research (IJMER), Vol.3, Issue.3, May-June. 2013, pp-1428-1434.
- [3]. Salehuddin Shamshinar, Stability of a six storey steel frame structure, International Journal of Civil & Environmental Engineering, Vol.13 No.06, 2011.
- [4]. User Manual STAAD.Pro.
- [5]. Chopra, A. K., Dynamics of Structures(1995): Theory and Applications to Earthquake Engineering, Prentice-Hall. Inc., Englewood Cliffs, New Jersey.
- [6]. IS 1893 : 2002, Indian Standard criteria for earthquake resistant design of frames, Part 1 General provisions and buildings, Draft of Fifth Revision, Bureau of Indian Standards, New Delhi, 2002.
- [7]. IS 800:2007, 'General construction in steel – Code of practice Bureau of Indian standards, New Delhi.
- [8]. IS: 875(Part-1)- 1987 'Code of Practice for Design Loads (Other than Earthquake) buildings and frames', Part-1 Dead load, Unit weight of building materials and stored materials, Bureau of Indian Standards, New Delhi.
- [9]. IS: 875(Part-2) - 1987 'Code of Practice for Design Loads (Other than Earthquake) buildings and frames', Part-2 Imposed loads, Bureau of Indian Standards, New Delhi.
- [10]. IS: 875(Part-3) - 1987 'Code of Practice for Design Loads (Other than Earthquake) for buildings and structures', Part-3 Wind loads, Bureau of Indian Standards, New Delhi.